

CARAVANS 20223

FARAMA

Inspiration for *your* adventures





Inspiration for *your* adventures



FARAMA Mobil's mission is to inspire memorable mobile leisure time experiences and this has guided our approach to designing and manufacturing caravans, for the last fifty-five years. Our vision for the Adria brand is for it to be the most desirable recreational vehicle brand, so we always seek to inspire with our design and innovation and back this up with premium quality. We offer class-leading models and bring new layouts and detailed improvements across all of our ranges and we are delighted to follow up the launch of the award-winning and luxurious Astella, with the inspired new generation Adora. Designed and manufactured at our state-of-the art production facilities, supported by class-leading warranties and over 500 Adria dealers across Europe and beyond, you will always feel at home, wherever you decide to roam. Enjoy many memorable experiences, on your adventures with FARAMA.





Watch the factory movie at: www.adria-mobil.com/movies

Why choose Adria?

The reasons for choosing Adria have never been so compelling. It is the combination of inspiring designs, elegant style and superior quality, which continues to grow the Adria family of owners.



FARAMA caravans regularly win independent awards for design, innovation, quality and value for money. See website for details.



PASSION

FARAMA Mobil has been designing and manufacturing Adria brand caravans since 1965, that's fifty-five years of experience, passionately applied to every vehicle.

INSPIRED DESIGN

We aim to inspire your adventures with caravans designed for living and designed to perform.

WORLD-CLASS MANUFACTURING

The most advanced production facilities in the industry, ISO 9001 & EFQM 5 star certified for business excellence and quality management standards.

PREMIUM QUALITY

FARAMA caravans have a reputation for quality, reliability and durability, using proven automotive manufacturing techniques. We make most of our own furniture and quality control the entire manufacturing and testing process.

PEACE OF MIND

FARAMA caravans come with a class-leading warranty and are supported by over 500 Adria dealers across Europe and beyond, backed up by a world-class parts supply and aftersales service.

SUSTAINABILITY

We are committed to environmental sustainability and complying with environmental standards. Our environmental management system is certified to ISO 14001. We are also committed to sustainable development and the prevention and reduction of environmental impacts.

Highlights

Choose from the luxury experience Astella, the all-seasons Alpina, the iconic Action, the light and bright Altea, the stylish Aviva and now, the new generation Adora.

FARAMA MEET THE NEW GENERATION

Designed around *you*.

Adora, our best-selling caravan, just got even better.
Everything is new and designed around you.



INSPIRED DESIGN

Our designers took inspiration from the Astella to bring a new design for new generation Adora.



SIGNATURE FEATURES

Our designers took the best of Adora's signature features and improved them.



INSPIRED SOLUTIONS

Innovative new solutions for inspired living.



HOME-STYLE FEELING

A feeling of home with elegant interiors and a special home-style ambiance.

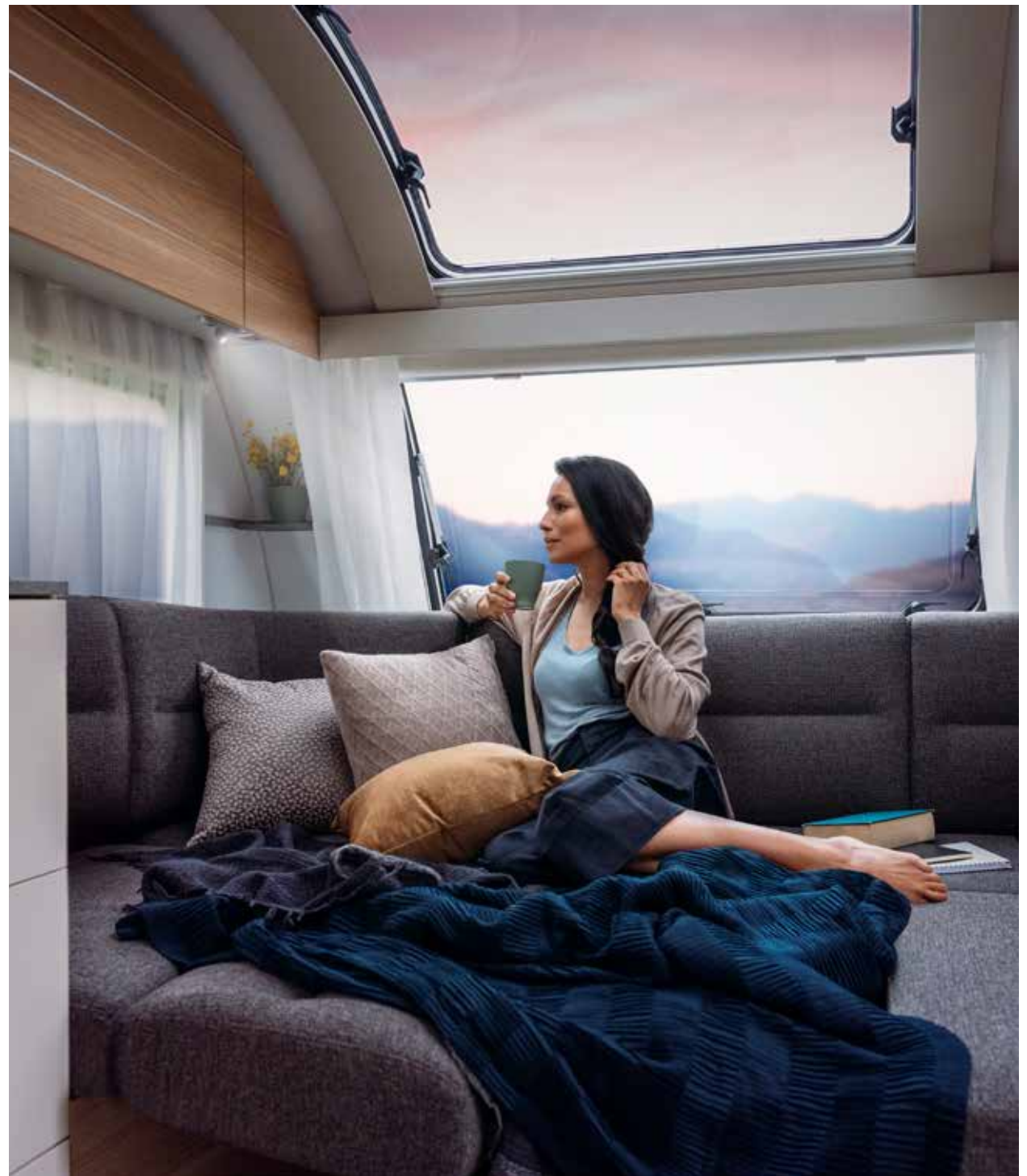



CONTEMPORARY LIVING SPACES

Inspired living spaces designed around the way you want to live.



ADORA LAYOUTS

Available in a choice of layouts.

ADRIA MACH

Features Adria MACH smart control mobile application.

NEW ADORA 613 PK

Adora 613 PK our new layout for families, with additional rear living accommodation.



Highlights

ASTELLA. NEW LUXURY LINE.

Experience a luxury holiday home like no other in the award-winning Astella. Exclusive layouts, each with panoramic double door for indoor-outdoor living.



*German Design Council -
Automotive Brand Contest
Award winner for product
and communication design.*



reddot design award



ALPINA

Still the best all-season caravan,
now with re-designed Ergo-bathroom
and even better water installations.

NEW EXTERIOR GRAPHICS

We've introduced new exterior graphics across all models.



ADRIA MACH

Choose Adria MACH smart control mobile application to control key functions, monitor utilities, for access to user manuals, navigation data and Mobile Office functions. (Available for Astella, Alpina and Adora).



NEW SOFT FURNISHINGS

A new choice of soft furnishings to make you feel more at home.



Inspiration. Discover more in the new edition of Inspirations magazine online

Designed for living

DETAILS MATTER

All of our caravans are designed for living, where the details matter and every centimetre counts. The science of layouts and construction, with everything in the right place, is learned over decades and Adria brings this experience to every layout.



1 Living

Contemporary new interior design and spacious living.

2 Kitchens

Intelligently designed kitchens with great space and functionality.

3 Bedrooms

A wide choice of bedroom formats, with comfortable mattresses.

4 Bathrooms

Hotel-style, practical bathrooms with quality fittings and touches of luxury.

5 Storage

Large volume optimised storage solutions throughout.

6 Multimedia

Smart solutions for entertainment and easier living.



Discover all our layouts
and experience
360 Walk-Throughs
at www.adria-mobil.com

 living

Contemporary living spaces with furniture selection complemented by a choice of textiles and soft furnishings.



Smart lighting management, with spot, LED and ambient lights, easy to control your ambience in all living spaces.

kitchens

Inspiring kitchen designs based on ergonomic principles, with style, great space and functionality, matched with the best appliances.



bathrooms

Hotel-style, practical bathrooms with quality fittings and touches of luxury.



☐ bedrooms

A choice of sleeping solutions, with easy to access beds with optimised dimensions, lighting design and really comfortable mattresses.



Every adventure starts with a great night's sleep.

**WAKE UP EACH MORNING
RESTED AND REFRESHED.**

luXe
★ MATTRESS ★

Our Luxe mattresses offer premium quality comfort and support. Featuring high resistance foam construction, easy-care fabric and natural protection against bacteria, odours and static.



FABRIC



AIR KNITTED FABRIC



ZIPPER



WASHABLE 40°



DRYING ON AIR
(NOT IN MACHINE)

SILVER PROTECTION



100% NATURAL



NON-TOXIC



ANTI-STATIC



ANTIBACTERIAL



ANTI-ODOR



storage

Large volume optimized storage throughout, places for all the things you need.



multimedia

Inspired entertainment solutions, including USB ports, sound systems and Bluetooth® amplifiers.



*Some features may not be available on all models.
Please check www.adria-mobil.com
for individual model specifications and technical details.*

Adria MACH makes everything easy!

Mobile Artificial Intelligence Communications Hardware.
Our smart control mobile application is available on **Astellia, Alpina**



NAVIGATION & POI

Navigation & Points of Interest information (including campsites, parking, dealers, landmarks).



MANAGE YOUR VEHICLE

Manage your vehicle (access interactive user manuals, key data, levelling information).



REMOTE* CONTROL OF KEY FUNCTIONS

Remote* control of key functions (lighting, heating, electricity, water, gas) with statistics and prediction feature.



MOBILE OFFICE*

Mobile Office* Wi-Fi hotspot functionality (access to web, IP radio and TV).

**SIM card needed.*

HOW MACH WORKS



INSTALL

the app from Google Play or Apple Store or visit adria-mobil.com/mach



CONNECT

to your vehicle.



CREATE

your Adria ID.



ENJOY

tailored experience.

Designed to perform



Real world performance

All FARAMA caravans are also designed to perform. Everything is meticulously designed, developed and tested to ensure your safety, comfort and enjoyment. Built to enjoy, built to last.

1_INSPIRED DESIGN.

Exclusive designs with dynamic front profiles, stylish rear walls and signature features such as large panoramic windows on many models.

2_CHASSIS.

Chosen and developed for robust construction, to enable safer handling and optimum weight management, with AL-KO as our preferred chassis partner.



3_BODY CONSTRUCTION.

Modular construction using the best materials and construction methods, including Adria's unique 'Complex' body construction.

4_CLIMATE CONTROL.

Designed for living, all year round, with optimized heating efficiency by Truma or Alde, precise engineering and testing in our climate chamber.



5_INSULATION.

The latest thermal insulation materials, sophisticated heat and air flow management to Adria's 'Thermo-build' standards and no 'cold-spots'.

6_AIRFLOW.

FARAMA sophisticated Air Flow System means every vehicle has integrated air-flow and ventilation, so no condensation.

7_WINDOWS & DOORS.

Large, advanced design panoramic windows with built-in features. All windows and doors integrated to ensure optimum natural lighting, ventilation, privacy and security.

8_FURNITURE & STORAGE.

Craftsman-built cabinetry integrated with heating and air flow for optimum thermal efficiency. Plenty of flexible storage in every vehicle too.

9_COMFORT.

Contemporary living spaces with optimized space and functionality for comfortable living and a home-style feeling.

10_CUSTOMER SERVICE.

Class-leading 2 Year General Warranty and 7 Year Water Ingress Warranty as standard, over 500 dealers and efficient after sales and parts service.

Body construction

CONSTRUCTION

FARAMA caravans have a reputation for being robustly built, which reflects our approach to design, construction and quality management.

FARAMA unique 'Complex' construction combines the torsional strength of wood, the durability of polyurethane and the moisture-stopping properties of polyester.



- 1 composite wood panel
- 2 polyurethane sealing
- 3 eps styrofoam
- 4 exterior polyester body shell cladding



- 5 exterior polyester body shell cladding
- 6 XPS Styrofoam insulation foam
- 7 Reinforced hardwood profile



Climate control

ADRIA THERMO-BUILD STANDARDS

Our caravans are built to FARAMA 'Thermo-build' standards making them suitable for use all year round. Featuring optimized insulation materials, precisely engineered heating design and FARAMA Air Flow System enabling a flow of air through the vehicle.

All vehicles are tested in our own climate chamber, from -40 to +60 degrees and in humidity from 45 % to 80 % between +30 and +60 degrees.

Comfort is assured in warmer conditions with good ventilation and integrated shading, including thermo-shielding and integrated screens in our panoramic windows.

Optional factory-fitted air conditioning is also available to order.



Adria MACH smart control application remotely controls heating, cooling and other vehicle utilities (available on Astella, Alpina and Adora).



HEATING

Easy to use **Truma** warm air distribution system with optional electrical underfloor heating. On selected models **Alde** heating, which is a liquid based central heating system, distributing heat evenly throughout the caravan. On selected models, Alde hot water floor heating available.



TECHNOLOGY

Plasma-treat technology is a robotized process which cleans and applies adhesive to ensure perfect sealing of window and door joints.

Caravans



PAGE

24



ALPINA

PAGE

32



ADORA

MEET THE NEW GENERATION

PAGE

44



ACTION

PAGE

52



ALTEA

PAGE

60



AVIVA

ALPINA

The ultimate all-seasons caravan.



ALPINA

Alpina, our premium caravan range, for all year-round use, now with new graphics and with improvements to the Ergo bathroom and water installations. A best-seller with its combination of eye-catching design, large panoramic window, contemporary spacious interiors, great performance and new soft furnishings.

The premium all-seasons caravan.



583 LP

613 UT

663 HT

663 PT

663 UK

753 HK

753 HT

753 UP

763 UK

903 HT



Adria MACH smart
control mobile app.

Exterior features

The Alpina is a best-seller in the colder climates of Scandinavia and now right across Europe, thanks to its high specification and all-year round performance.



1 FARAMA 'Complex' construction with additional floor insulation.

2 Exclusive design with new graphics and wide entrance door.

3 Exterior rear LED lights with curtain technology.

4 Extra-large panoramic window on most layouts.

5 Seitz DeLuxe windows with integrated mosquito net and roller blinds.

6 AL-KO chassis.



7 Continental tyres and new FARAMA alu wheel design.



Interior features



I. Large elegant living spaces for atrium-style living.

II. Optimized storage including concave design deep cupboards.

III. User-friendly solutions including Bluetooth® amplifier, USB ports.

IV. Rich, controllable lighting system for different ambiance.

V. Smart kitchen with home comfort and the best appliances.

VI. New Ergo bathroom with improved water installations.

VII. Alde integrated heating.

Alde



Alpina provides true loft-style living unlike any other caravan, with extra-large living spaces and a stylish, luxury ambiance. It's also a highly practicable and robust caravan packed with features.



ALPINA LAYOUTS

ALPINA

583 LP
 L 6411 (mm) | 
 W 2460 (mm) | 4

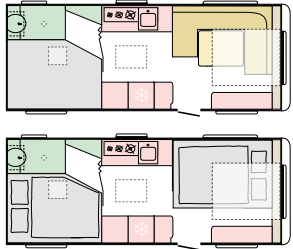

613 UT
 L 6761 (mm) | 
 W 2460 (mm) | 4

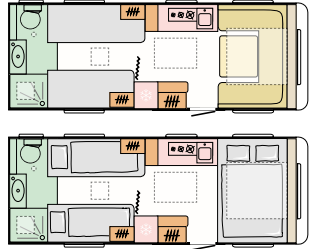

663 HT
 L 7281 (mm) | 
 W 2460 (mm) | 5

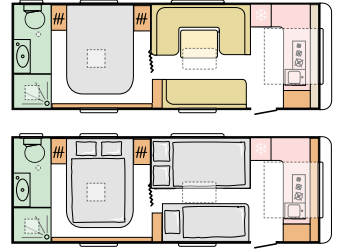

663 PT
 L 7251 (mm) | 
 W 2460 (mm) | 6/7

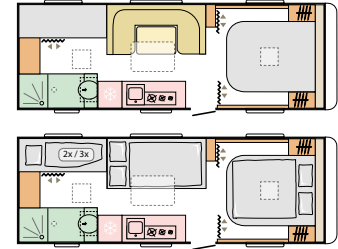

663 UK
 L 7232 (mm) | 
 W 2460 (mm) | 6/7

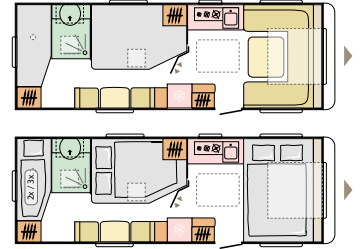

753 HK
 L 8091 (mm) | 
 W 2460 (mm) | 7/8

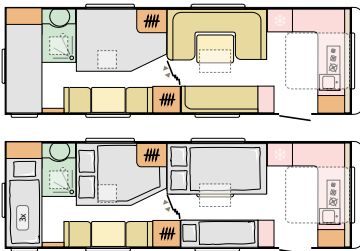

753 HT
 L 8091 (mm) | 
 W 2460 (mm) | 5

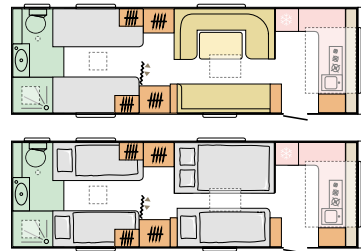

753 UP
 L 8110 (mm) | 
 W 2460 (mm) | 6

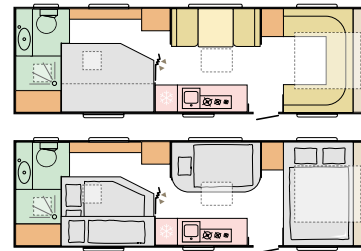

763 UK
 L 8236 (mm) | 
 W 2460 (mm) | 8/9

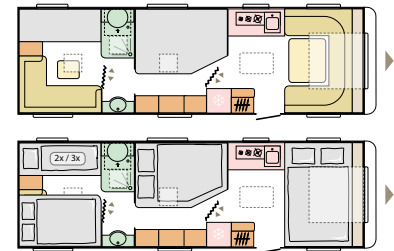

903 HT
 L 9533 (mm) | 
 W 2460 (mm) | 9

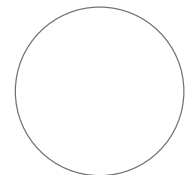
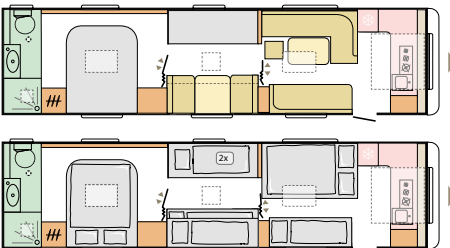

KEY features

- Exclusive exterior design with new graphics.
- 'Comprex' body construction and 600mm wide entrance door.
- Exterior LED lights with curtain technology.
- Seitz DeLuxe windows with integrated mosquito net and roller blinds.
- AL-KO chassis on all models.
- Large living spaces, with elegant interiors and soft furnishing choices.
- Extra-large panoramic window on most layouts.
- Comfortable bedrooms with a selection of bed formats.
- Optimized storage including concave design deep cupboards.
- User-friendly solutions including Bluetooth® amplifier, USB ports.
- Easy fold-out bunk bed solution on selected layouts.
- Controllable lighting system for different ambiance.
- Smart kitchen with 3 burners and best appliances.
- New Ergo bathroom with improved water installations.
- Alde integrated heating.

KEY options

- FARAMA MACH smart control mobile app.
- Factory-fitted air Conditioning.
- Choice of soft furnishings.

NEW soft furnishings

There's a wide choice of soft furnishings and cushion colourways available for a much more personal style – yours!

Go to www.adria-mobil.com for more information and vehicle applicability.

TEXTILES selection

POMMERY



MORGAN



EDGAR



L. MATTHIASE



DREAM HARMONY



SUMMER VIBES

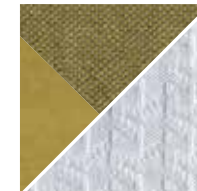

BROWNIES

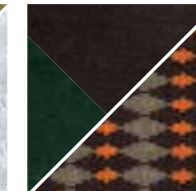

GREY PLANET

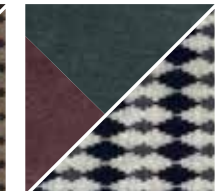

MYSTIC GARDEN



WARM BROWNS

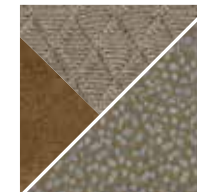

A D O R A

Designed around you.

MEET
THE NEW
GENERATION



ADORA

MEET THE NEW GENERATION

The new generation Adora, our best-selling caravan just got even better. The most aerodynamic caravan now available, with distinctive Adria silhouette and extra-large in-line panoramic window, wider door and smart storage. Feel inspired and at home in the elegant interior with new kitchen, bathroom, bedroom and contemporary living spaces.

Everything is new and designed around you.



472 UP

502 UL

522 UP

542 UL

572 UT

573 PT

613 HT

613 PK

613 UT

673 PK

753 UK





INSPIRED DESIGN

Our designers brought inspiration from the award-winning Astella to bring a whole new design to this new generation caravan.

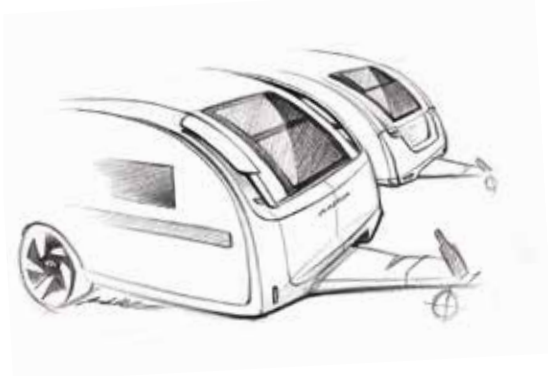

NEW SILHOUETTE



NEW INTEGRATED FEATURES

Exterior features

- 1 NEW EXTERIOR DESIGN**, clean and elegant with new graphics.
- 2 NEW REAR WALL DESIGN**, with new multi-functional full LED lights.
- 3 NEW PANORAMIC WINDOW**, in-line wider design, on most layouts.
- 4 PERFORMANCE CHASSIS FROM AL-KO** with AKS stabiliser coupling. **AL-KO**
- 5 INNOVATIVE WIND DIFFUSERS**, for more efficient towing.
- 6 WIDE ENTRANCE DOOR** and double-glazed 'flat' tinted windows.
- 7 NEW HIGHER VOLUME STORAGE**, tent profile and integrated handles.
- 8 ALLOY WHEELS** and Continental tyres.





SIGNATURE FEATURES

Our designers took the best of the Adora's signature features and improved them.



NEW IN-LINE PANORAMIC WINDOW

Our new in-line design brings light and the feeling of space for 'atrium-style living'. Includes integrated shading and ventilation features.



NEW LED LIGHTS

New design full LED multifunctional rear lights for automotive style and functionality.



NEW AERODYNAMIC WIND DIFFUSERS

This innovative feature, aids wind diffusion, look stylish and help towing efficiency.



PERFORMANCE CHASSIS

AL-KO Chassis for secure and stable towing, with AKS stabiliser coupling and optional ATC trailer control system.



AL-KO



ADRIA MACH

Features Adria MACH smart control mobile application.



NEW EXTERIOR GRAPHICS

The new Adora has new automotive style graphics, with familiar Adria lines.





HOME-STYLE FEELING

The new generation brings a feeling of home with elegant interiors with bigger spaces, new softer, more integrated forms and a special home-style ambiance.



•
New lighting system for controllable ambiance.

•
Atrium-style living with extra-large panoramic window.

•
New sound system with integrated hidden speakers.

•
Organized storage with dedicated spaces for personal items.

•
Heating by Truma and Alde.



Interior features



I. All-new home-style interior design for atrium-style living.

II. Comfortable bed solutions with Evopore® mattresses.

III. Digital controller, sound system, Bluetooth® amplifier & USB ports.

IV. Contemporary living spaces with outstanding comfort.

V. New kitchen design with great storage and best appliances.

VI. New Ergo bathroom design with innovative optional storage solutions.

VII. Alde or Truma heating, plus optional electrical floor heating.



Interior



CONTEMPORARY LIVING SPACES

The Adora's inspired living spaces means everything is designed around the way you want to live.

LIVING ROOM

The large panoramic window means 'atrium-style' living, with natural light, controllable shading and ventilation.

- Living room beneath large panoramic window.
- Dinette with comfortable seating.
- Easy additional bed set up.
- A durable, light weight put away table.
- Head rests for extra comfort.



KITCHEN

The new home-style kitchen design is inspired by the best home kitchens.

- Elegant concave cupboards with more volume.
- High loading capacity drawers.
- Multifunctional hanging profile.
- High quality appliances.

**BATHROOM**

Our new Ergo bathroom, features a new fold-away sink, extra space, new lighting and plenty of storage.

- Improved fold-away system.
- Efficient draining and serviceability.
- Storage for personal things.
- Controllable lighting.



Interior



CONTEMPORARY LIVING SPACES

A choice of layouts designed for the way you want to live, including unique layouts for families.



ADORA 613 PK

Adora 613 PK our new layout for families, for 2 adults and 1-3 kids, all with 2m beds. Brilliant for guests too thanks to the Adria Exclusive Design® additional rear living accommodation, which is also great day rest or play space under the new rear panoramic window, includes 2 TV points.



BEDROOM

New bedroom designs, with all formats of bed, for a great night's sleep.

- Higher beds.
- Luxury Evopore® mattress.
- Controllable lighting.
- Storage for personal things.



INSPIRED SOLUTIONS

Everything has been reviewed and improved, with innovative new solutions for inspired living and maximum permitted weight loading as standard.



A D O R A R A N G E

ADRIA MACH



smart control mobile application is available as an option. MACH controls key functions, monitor utilities, gives access to user manuals and provides navigation data and Mobile Office functions.

MULTIMEDIA

Enjoy more connected living, with new digital control panel and a range of multimedia solutions including new high-quality sound system with hidden speakers, Bluetooth® amplifier, TV point and holder, and multiple USB ports.



STORAGE

More storage than you'd think possible. Easy access gas storage outside and inside there's large volume concave design cupboards. Large wardrobe design and multi-purpose kitchen storage, including large capacity drawers and utensils track. Bathroom storage for personal items, including innovative optional removable storage solution.



ADORA LAYOUTS

ADORA

472 UP 
 L 5385 (mm) |
 W 2296 (mm) | 4

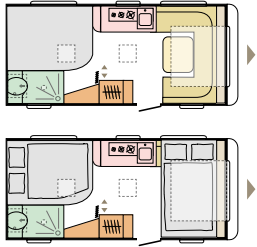

502 UL 
 L 5725 (mm) |
 W 2296 (mm) | 5

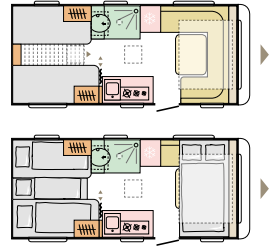

522 UP 
 L 5910 (mm) |
 W 2296 (mm) | 4

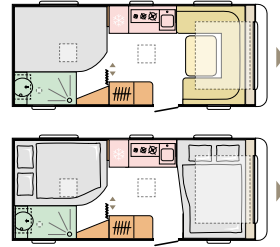

542 UL 
 L 6150 (mm) |
 W 2296 (mm) | 5

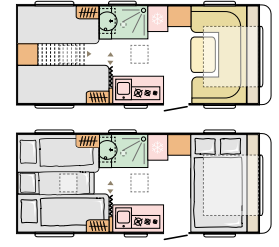

572 UT 
 L 6400 (mm) |
 W 2296 (mm) | 4

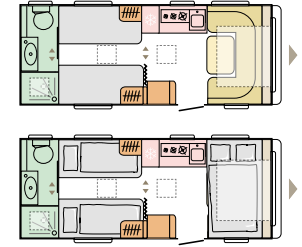

573 PT 
 L 6365 (mm) |
 W 2460 (mm) | 6/7

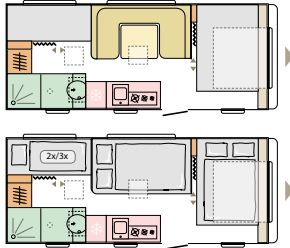

613 HT 
 L 6855 (mm) |
 W 2460 (mm) | 4

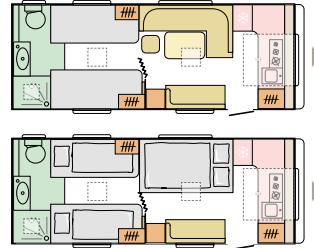

613 PK 
 L 6855 (mm) |
 W 2460 (mm) | 7



613 UT 
 L 6856 (mm) |
 W 2460 (mm) | 4

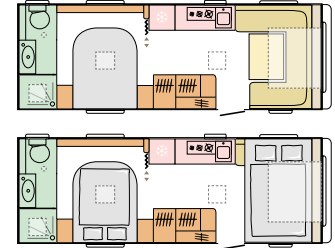

673 PK 
 L 7402 (mm) |
 W 2460 (mm) | 7

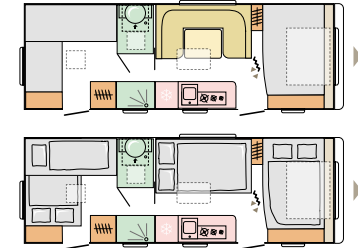

753 UK 
 L 8182 (mm) |
 W 2460 (mm) | 6/7

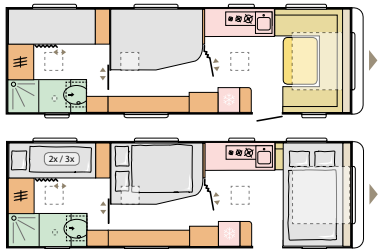

KEY features

- New exterior clean design with integrated features.
- GFK body construction, AL-KO chassis, with AKS stabiliser coupling.
- Exclusive new rear wall design with new multifunctional full LED lights.
- Integrated wind diffusers, handles, tent profile, storage and lights.
- Extra-large in-line wider panoramic window on most layouts.
- Wide entrance door and double-glazed 'flat' tinted windows.
- All-new interior design, with contemporary living spaces.
- Comfortable bed solutions with Evopore® mattresses.
- New digital controller, sound system, Bluetooth® amplifier & USB ports.
- All-new living and dining area, with outstanding comfort.
- New kitchen design with great storage and best appliances.
- New Ergo bathroom design with innovative optional storage solutions.
- Alde or Truma heating, plus optional electrical floor heating.
- Couple, family, teenager and child friendly layouts.

KEY options

- FARAMA MACH smart control mobile app.
- AL-KO ATC trailer control system.
- Innovative optional storage solutions.
- Choice of soft furnishings.

NEW soft furnishings

TEXTILES selection

MISTY ROSE



DARK ALMONDS



STONE ISLAND



MORGAN



DREAM HARMONY

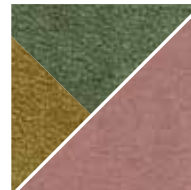

SUMMER VIBES

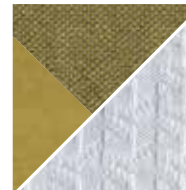

BROWNIES

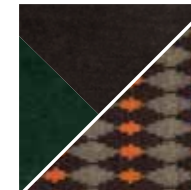

GREY PLANET

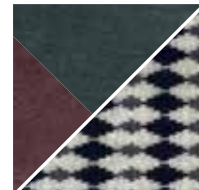

MYSTIC GARDEN



WARM BROWNS

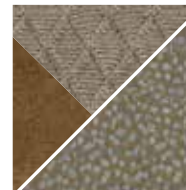

ACTION

Love the new original.



ACTION

The Action, the original iconic, light-weight and stylish caravan for active holidays, in three sporty colours.
 A caravan which always puts a smile on your face and delivers on space, features and comfort.
 Contemporary interior with smart kitchen, ergo bathroom and comfortable sleeping.

You'll love the new original.

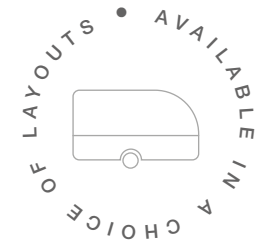

361 LH

391 LH

391 PD

391 PH



Exterior features

The Action is a much loved, iconic caravan, a true original which delivers on space, features and comfort.



7
YEAR^{ADRIA}
WATER INGRESS
warranty



1 Iconic exterior shape and integrated features.

2 GFK polyester body with choice of colour body mouldings.

3 Adaptation for bicycle rack for rear wall (optional).

4 Panoramic window on all layouts.

5 AL-KO chassis and AKS on all models.



6 Features new exterior graphics.

7 Model 391PH with optional exterior Smart grill.

Interior features



I. Flexible living spaces with elegant interiors.

II. Comfortable sleeping accommodation.

III. Truma heating, with optional electrical floor heating.

IV. Adria Smart kitchen with the best appliances.

V. FARAMA Ergo bathroom with foldaway sink.

VI. Multiple USB ports.

VII. Loudspeakers with available Bluetooth® amplifier.





Action is a much-loved caravan. Compact in size with highly flexible living spaces. A truly original caravan packed with smart features.





ACTION

361 LH ☾
 L 4010 (mm) |
 W 2196 (mm) | **3**

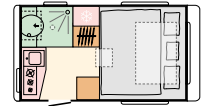
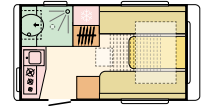

391 LH ☾
 L 4310 (mm) |
 W 2196 (mm) | **3**

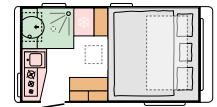
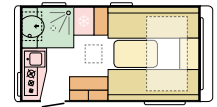

391 PD ☾
 L 4460 (mm) |
 W 2196 (mm) | **2**



391 PH ☾
 L 4310 (mm) |
 W 2196 (mm) | **4**

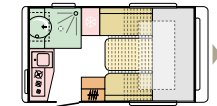

KEY features

- Iconic exterior shape with sporty graphics.
- GFK polyester body with a choice of colour body mouldings.
- Externally accessible garage storage.
- Panoramic window on all layouts.
- AL-KO chassis and AKS stabiliser coupling.
- Flexible living spaces with elegant interiors.
- Comfortable sleeping accommodation.
- Truma heating with optional electrical floor heating.
- Adria Smart kitchen with 3 burners and best appliances.
- Adria Ergo bathroom with toilet, shower and foldaway sink.
- Controllable lighting for different ambiance.
- Multiple USB ports.
- Loudspeakers with Bluetooth® amplifier.
- Integrated garage solution.

TEXTILES selection

BRUNELLO BLACK



BRUNELLO MINT



KEY options

- Different colour body mouldings.
- Additional electrical floor heating.
- Adaptation for bicycle rack (rear wall).
- Slide-out external smart grill on 391 PH.
- Choice of soft furnishings.

NEW soft furnishings

BRUNELLO BLACK



BRUNELLO MINT



ALTEA

Light, bright and fun!



ALTEA

The Altea, a comfortable, practical caravan for a lighter, brighter and more fun experience, now featuring new graphics. Contemporary interior with practical layouts, innovative features, improved lighting and storage, better comfort and more practicality. Choice of soft furnishings and equipment.

Enjoy a light, bright and fun caravan experience.



ALTEA4FOUR

362 LH

402 PH

432 PX

472 KP

472 PK

472 PU

492 LU

502 UL

542 PH

542 PK

552 PK

Exterior features

The Altea is a really elegant and comfortable caravan, perfect for holidays with its combination of space, comfort and features.



1 Exclusive exterior design with new graphics.

2 Two-part entrance door with window option.

3 Double-glazed 'flat' design tinted windows.

4 GFK polyester body with embossed aluminium sidewalls.

5 AL-KO chassis.

AL-KO

6 Front gas bottle storage compartment.

7 Model 472 KP optional integrated slide-out kitchen unit.

Interior features



I. Contemporary interior with innovative lighting system.

II. Smart kitchen with the best appliances.

III. Ergo bathroom with foldaway sink.

IV. Controllable lighting for different ambiance.

V. Modern textiles in soft and durable materials.

VI. Loudspeakers with pre-installation for Bluetooth amplifier.

VII. Truma heating with optional electrical floor heating.





ALTEA RANGE

Altea is a joy to use, thanks to its inspired contemporary design and its light, spacious feeling. It's a highly practicable and robust caravan, available in many layouts.



ALTEA LAYOUTS

ALTEA

ALTEA4FOUR 362 LH 
 L 4280 (mm) | 3
 W 2296 (mm)

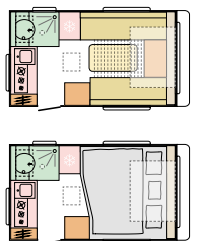

402 PH 
 L 4637 (mm) | 4
 W 2296 (mm)

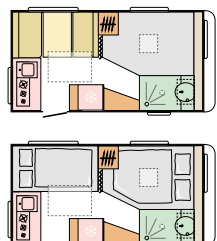

432 PX 
 L 4970 (mm) | 4
 W 2296 (mm)

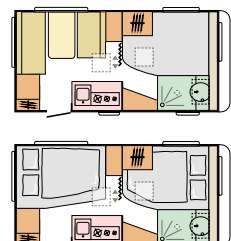

472 KP 
 L 5319 (mm) | 4
 W 2296 (mm)



472 PK 
 L 5319 (mm) | 6
 W 2296 (mm)

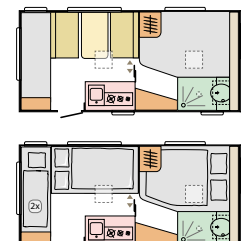

472 PU 
 L 5320 (mm) | 4
 W 2296 (mm)

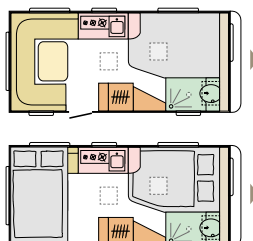

492 LU 
 L 5530 (mm) | 4
 W 2296 (mm)

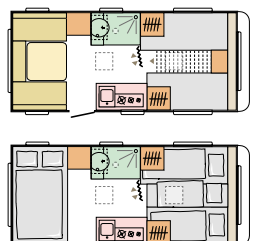

502 UL 
 L 5655 (mm) | 5
 W 2296 (mm)

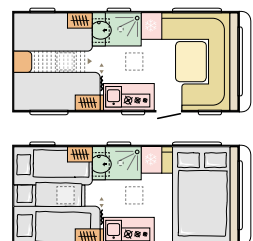

542 PH 
 L 6020 (mm) | 4
 W 2296 (mm)

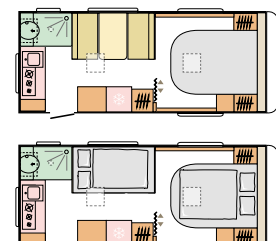

542 PK 
 L 6020 (mm) | 6/7
 W 2296 (mm)

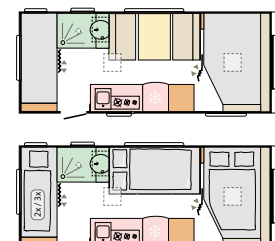

552 PK 
 L 6159 (mm) | 6/7
 W 2296 (mm)

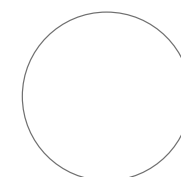
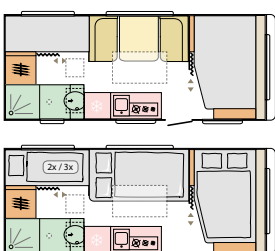

L = LENGTH W = WIDTH  NUMBER OF BERTHS  KITCHEN  TABLE  SEATING AREA  WARDROBE  BERTHS  BATHROOM  FLOOR

KEY features

- Exclusive exterior design with new graphics.
- Double-glazed 'flat' design tinted windows.
- GFK polyester body with embossed aluminium sidewalls.
- Two-part door with window option.
- Upgraded electrical equipment and control panel.
- Upgraded loading capacities on family layouts.
- AL-KO chassis.
- Front gas bottle storage compartment.
- Contemporary interior style with innovative lighting system.
- Wide choice of layouts and bedroom formats.
- Smart kitchen with optimized worktop, storage and appliances.
- Ergo bathroom with foldaway sink.
- Controllable lighting for different ambiance.
- Smart storage solutions.
- Modern textiles with softer more durable materials.
- Pre-installation loudspeakers, Bluetooth® amplifier & USB ports.
- Truma heating with optional electrical floor heating.

KEY options

- Kid's Pack on Family layouts.
- Model 472 KP optional external slide-out kitchen unit.
- Choice of soft furnishings.
- Choice of soft furnishings.

NEW soft furnishings

There's a wide choice of soft furnishings and cushion colourways available for a much more personal style – yours!

Go to www.adria-mobil.com for more information and vehicle applicability.

TEXTILES selection

FLAVIE



SETH



GILLES



DREAM HARMONY

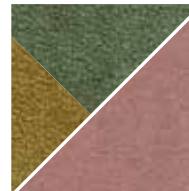

SUMMER VIBES

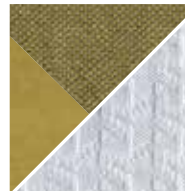

BROWNIES

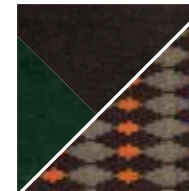

GREY PLANET

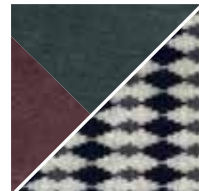

MYSTIC GARDEN



WARM BROWNS

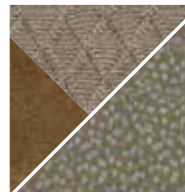

A V I V A

A new style of camping.



AVIVA

The Aviva, the European Innovation award-winner, featuring new graphics, is such an original, comfortable and easy caravan to own and to use. Elegantly designed stylish interior, packed with innovative features and with a choice of soft furnishings.

Experience a new style of camping.



360 DD

360 DK

400 DK

400 PS

442 PH

472 PK

492 LU

522 PT

563 PT



Exterior features

The Aviva brings an innovative, new style to camping thanks to its combination of space, comfort and practical features.



1 Exclusive exterior design with new graphics.

2 Exclusive, innovative and flexible front storage compartment.

3 GFK body with embossed aluminium sidewalls.

4 AL-KO chassis.
AL-KO

5 Integrated tent profile and third stop light.

Interior features



I. Elegant interior living spaces, with choice of soft furnishings.

II. Innovative, exclusive storage solutions.

III. User-friendly solution - loudspeakers, Bluetooth® amplifier, USB ports.

IV. Comfortable sleeping solutions, sleeping up-to 7 people.

V. Smart kitchen with 2 or 3 burners, 80 or 140 l fridge (varies by model).

VI. Bathroom, with toilet, shower, sink & 'to go' accessories.

VII. Truma heating with optional electrical floor heating.





Aviva offers a whole new style of camping, with its many innovative features and stylish yet ultimately simple solutions, in the kitchen, bathrooms all wrapped up in a robust and highly practical caravan.



AVIVA LAYOUTS

AVIVA

360 DD 
 L 4142 (mm) |
 W 2090 (mm) | **3**

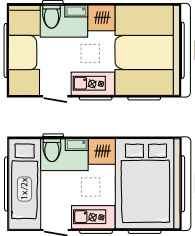

360 DK 
 L 4142 (mm) |
 W 2090 (mm) | **4/5**

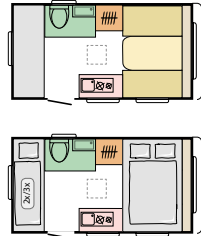

400 DK 
 L 4492 (mm) |
 W 2090 (mm) | **4/5**

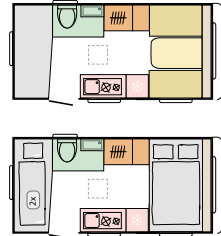

400 PS 
 L 4492 (mm) |
 W 2090 (mm) | **4**



442 PH 
 L 4872 (mm) |
 W 2300 (mm) | **4**

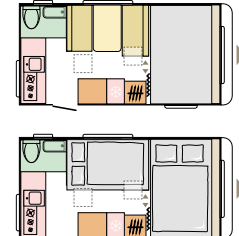

472 PK 
 L 5174 (mm) |
 W 2300 (mm) | **6**

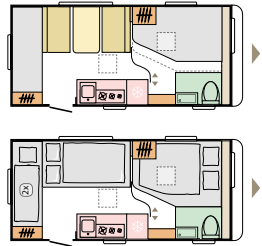

492 LU 
 L 5384 (mm) |
 W 2300 (mm) | **5**

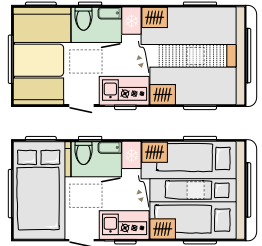

522 PT 
 L 5664 (mm) |
 W 2300 (mm) | **6/7**

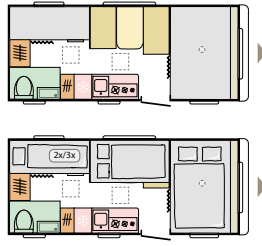

563 PT 
 L 6154 (mm) |
 W 2450 (mm) | **6/7**

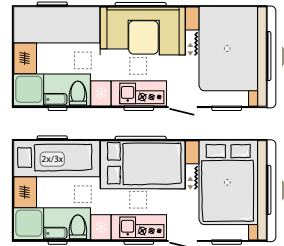

L = LENGTH W = WIDTH

 NUMBER OF BERTHS

 KITCHEN

 TABLE

 SEATING AREA

 WARDROBE

 BERTHS

 BATHROOM

 FLOOR

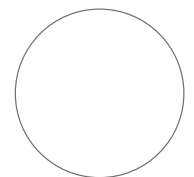

KEY features

- Exclusive exterior design with new graphics.
- Exclusive, innovative and flexible front storage compartment.
- Solid body in polyester with embossed aluminium sidewalls.
- AL-KO chassis.
- Elegant interiors and new soft furnishing choices.
- Innovative, exclusive storage solutions.
- User-friendly solutions - loudspeakers, Bluetooth® amplifier & USB ports.
- Comfortable sleeping in a choice of bed formats.
- Stylish privacy curtain.
- Smart kitchen with 3 burners and best appliances.
- Bathroom, with toilet, shower, sink & 'to go' accessories.
- Pre-installation for air-conditioning.

KEY options

- Truma heating, Trumavent and floor heating (by layout).
- Kid's Pack on family layouts.
- Choice of soft furnishings.

NEW soft furnishings

TEXTILES selection

BAHIA



FLORIAN



ROBYN



OLIVIA



DREAM HARMONY

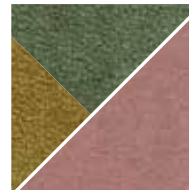

SUMMER VIBES

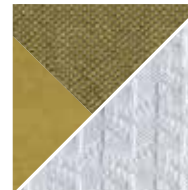

BROWNIES

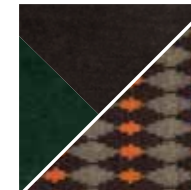

GREY PLANET

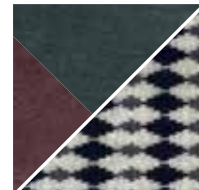

MYSTIC GARDEN



WARM BROWNS

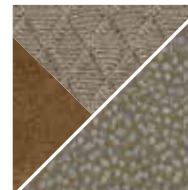

seating

Our caravans offer improved seating for more support and more comfort. After all, in every great adventure, you need to relax.

POMMERY



Alpina

MORGAN



Alpina

EDGAR



Alpina

LEATHER MATHISSE



Alpina

MISTY ROSE



Adora

DARK ALMONDS



Adora

STONE ISLANDS



Adora

MORGAN



Adora

BRUNELLO BLACK



Action

BRUNELLO MINT



Action

FLAVIE



Altea

GILLES



Altea

SETH



Altea

BAHIA



Aviva

FLORIAN

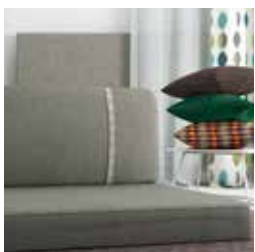

Aviva

OLIVIA



Aviva

ROBYN



Aviva

With your choice of textile you can select any decorative cushion set.



soft furnishings & decorative cushions

There's a wide choice of soft furnishings and cushion colourways available for a much more personal style – yours!

DREAM HARMONY



SUMMER VIBES



BROWNIES



GREY PLANET



MYSTIC GARDEN



WARM BROWNS



World-class partners

**ADRIA RECREATIONAL VEHICLES ARE
THE CHOICE OF CHAMPIONS**



TINA MAZE

Double World Champion and double Olympic gold medalist. One of the best skiers of all time, Tina Maze, from Slovenia, regularly uses her Twin Supreme to follow the snow for skiing and wind, for windsurfing.

See our #vanlife feature at www.adria-mobil.com

ADRIA MOBIL CYCLING TEAM

The Adria-Mobil Cycling Team are the top Slovenian cycling team in the UCI European Tour. For more information visit www.adria-mobil-cycling.com



PRIMOŽ ROGLIČ

World-class cyclist and Adria Ambassador, from Slovenia, fourth in the 2018 Tour de France, Tour of Slovenia 2018 winner and third in the 2019 Giro d'Italia. Primož uses his Sonic Supreme to support his training, competing and for holidays with his family.



JAKOV FAK

Silver medal biathlon winner at the 2018 Winter Olympics and Bronze in Vancouver in 2010, is an Adria ambassador and Sonic Supreme user.



KTM FACTORY RACING TEAM

Every January since 2013, a fleet of Adria Sonic and Matrix motorhomes are taken on the Dakar Rally in South America by Red Bull KTM Factory Racing. Custom-designed Adria Twins also support their team's MXGP World Championship.



SOCIAL MEDIA

Join the Adria family on Facebook, Instagram, YouTube and Pinterest to share your adventures.



DISCOVER MORE IN THE NEW EDITION OF INSPIRATIONS MAGAZINE, ONLINE AT adria-mobil.com/inspirations



FARAMA